

REVISIONS			
REV	DESCRIPTION	DATE	APPROVED
1	Change material	4/8/16	<i>[Signature]</i>

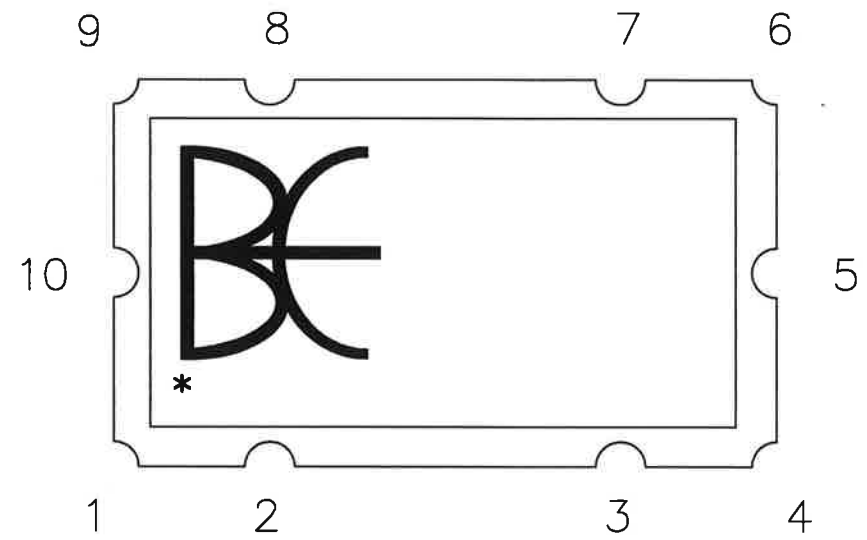
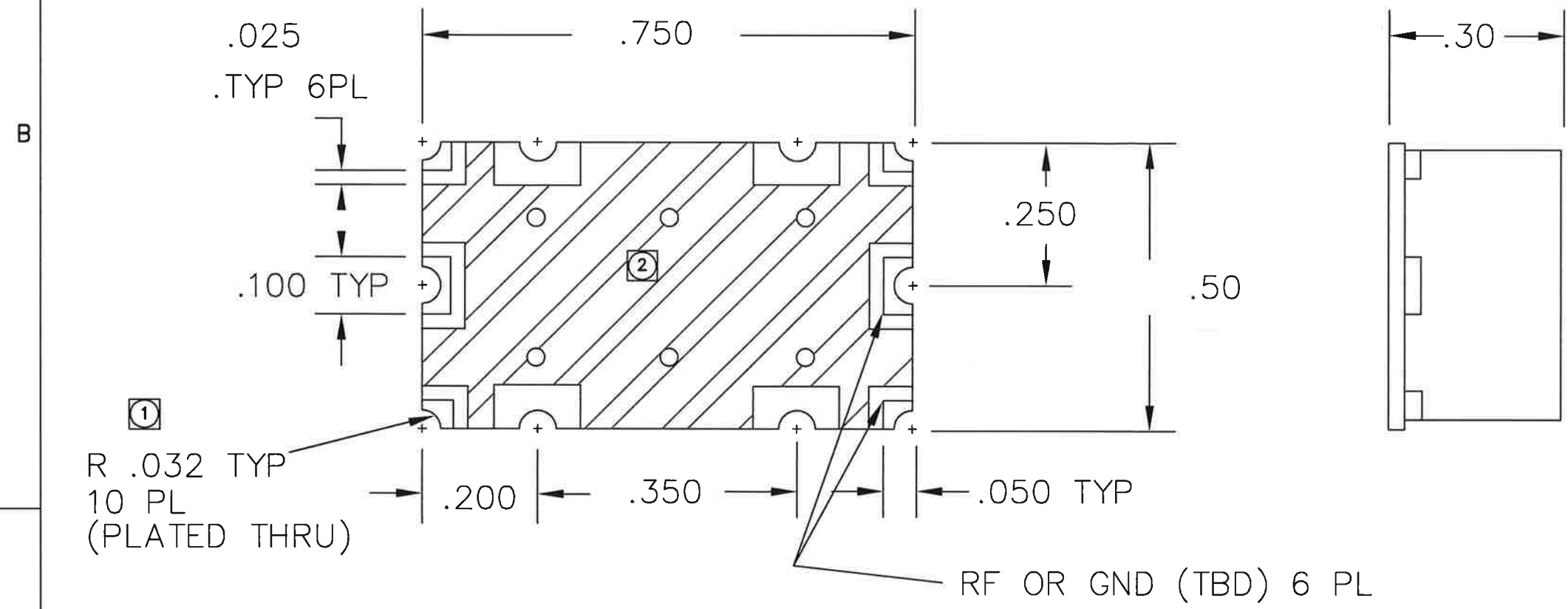

- ② Solder Mask: SR1000, LPI or equivalent.
- ① Location of plated thru holes are to be held at +/- .005.

THE INFORMATION CONTAINED IN THIS DRAWING IS THE SOLE PROPERTY OF BREE ENGINEERING. ANY REPRODUCTION IN PART OR WHOLE WITHOUT THE WRITTEN PERMISSION OF BREE ENGINEERING IS PROHIBITED.

UNLESS OTHERWISE SPECIFIED DIMENSIONS ARE IN INCHES & TOLERANCES ARE: .XXX .XX ANGLES ±.005 ±.01	CAD GENERATED DRAWING DO NOT MANUALLY UPDATE		BEE BREE ENGINEERING
	DWN BE	DATE 07-20-01	
MATERIAL Nelco 4000-13-EP Nickel	CHK		OUTLINE
	RESP ENG		
	MFG ENG		
MATERIAL N/A	QUAL ENG		
	Scale for REFERENCE ONLY		
SIZE CAGE CODE DWG NO		REV	
B 1K3H5 700057		1	
SCALE 4:1		SHEET 1 OF 1	